

Termination available:

Solder Terminals

2.8 mm (.110) Fast-on Terminals

4.8 mm (.187) Fast-on Terminals



Specifications:

Contact Material: Nickel Plated Brass
 Body Material: Nylon 6.6 94 V0
 Manufacturers Specification: EN60320
 Specification: UL 498

International Amperage: 2.5 Amp
 Voltage: 250 Volt

UL / CSA Amerage: 2.5 Amp.
 Voltage: 125 Volt:

All Dimensions are in mm

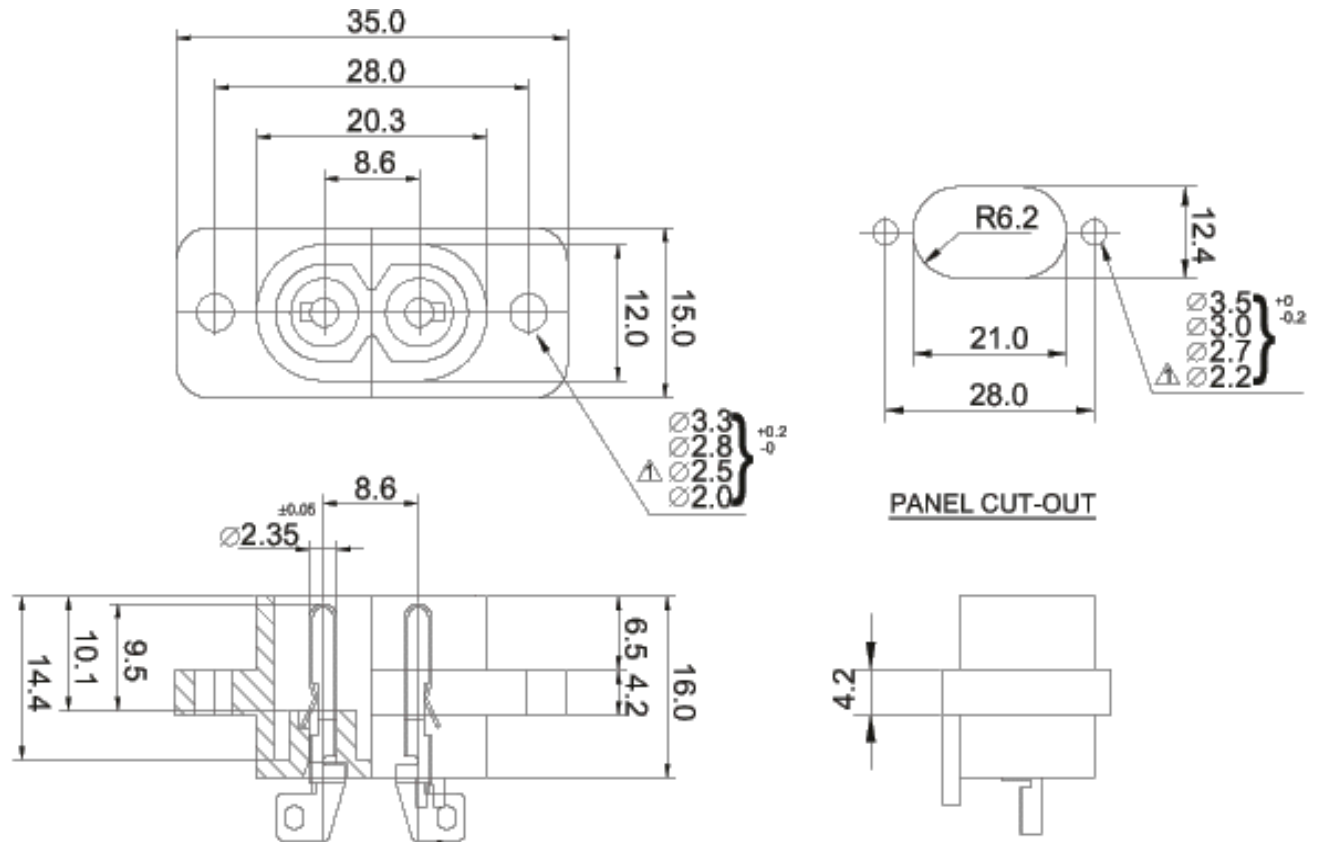

675 S. Lively Blvd.
 Elk Grove Village
 Illinois 60007

Agency Approvals



CUSTOMER	
PARTNO.	

DATE: October 2004	Drawn By: J.Balck	GENERAL SPECIFICATION	PAGE: 1 OF 1	
CHANGE ISSUE:			DWG.NO. AEL-JR201	REV. 0
APPROVED		Power Inlet IEC 320-C8		